

Thread and Countersunk Dimensions

d1	Pitch mm	d2	t1	t2	d3	d4	t4
M3	0.5	2.5	6	10	3.5	6.5	3.5
M4	0.7	3.3	8	12	4.5	8.0	4.5
M5	0.8	4.2	10	14	5.5	9.5	6.0
M6	1.0	5.0	11	15	6.6	11.0	7.0
M8	1.25	6.8	14	20	9.0	15.0	9.0
M10	1.5	8.5	19	25	11.0	18.0	11.0
M12	1.75	10.2	25	32	14.0	20.0	13.0
M14	2.0	12.0	25	32	16.0	24.0	15.0
M16	2.0	14.0	28	34	18.0	26.0	17.0
M18	2.5	15.5	32	40	20.0	29.0	19.5
M20	2.5	17.5	33	42	22.0	32.0	21.5
M22	2.5	19.5	37	48	24.0	35.0	23.5
M24	3.0	21.0	38	52	26.0	38.0	25.5
M27	3.0	24.0	46	60	29.0	42.0	28.5
M30	3.5	26.5	55	70	32.0	48.0	32.0
M36	4.0	32.0	65	85	39.0	57.0	38.0
M42	4.5	37.5	75	95	45.0	66.0	44.0
M48	5.0	43.0	85	110	52.0	76.0	50.0

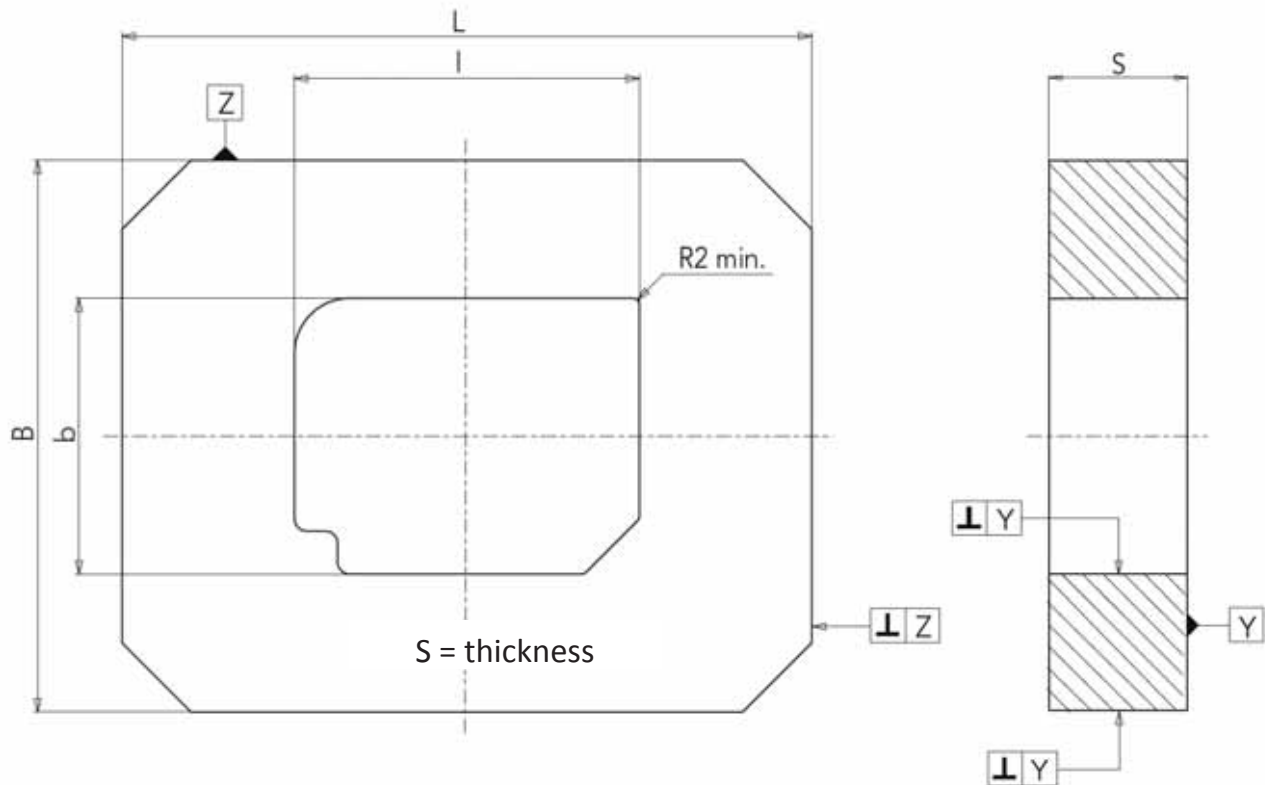

Tolerances / Allowance for Machining

B / L b/l	S Maximum	Mat Allowance B /L-b/l	Tolerance B/L-b/l	Available Material	Available Material
<400	<140	8mm	-2.0mm	S355 WA	TX33
<600	<140	9mm	-2.0mm	S355 WA	TX33
<600	<165	10mm	-3.0mm	S355 WA	TX33
⊥ Y	1.0 / 100mm				
⊥ Z	0.2 / 100mm				